



Product special

STAINLESS STEEL HANDLING PRODUCTS



· Introduction	3
· Technical info	4
· Manual pallet trucks	5
· Manual scissor pallet trucks	8
· Semi-electric scissor pallet trucks	9
· Weighing pallet trucks	10
· Manual lift tables	12
· Table trolleys	14
· Minipuller	15
· Salt spreader	16
· Skips	17
· Accessories	18
· Notes	22



Stainless steel is used everywhere, especially in the food and pharmaceutical industry. The extremely durable material has great resistance against low and high temperatures and is easy to clean.

TVH offers you a wide range of handling equipment and attachments made of stainless steel. The drawings shown on page 4 will guide you to the right choice: semi-stainless or 100% stainless.

Find all information about these stainless steel products in this product special and choose to work efficiently in your work environment.





100% STAINLESS STEEL MANUAL PALLET TRUCK

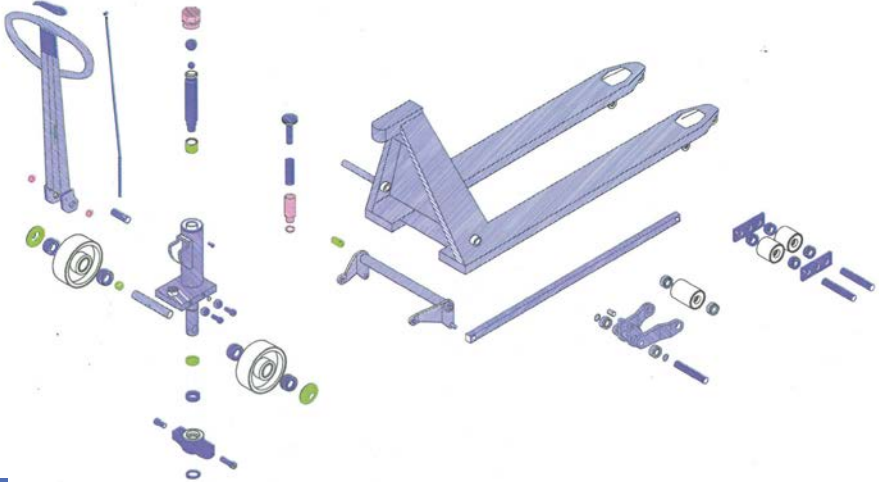

- Stainless steel
- Nylon/Pom
- Brass/Bronze

All pins, axles, bearings and bolts: stainless steel
 Stainless surfaces on pump, chassis, towbar, pushrod and rocker arm: shotblasted

SEMI-STAINLESS STEEL MANUAL PALLET TRUCK

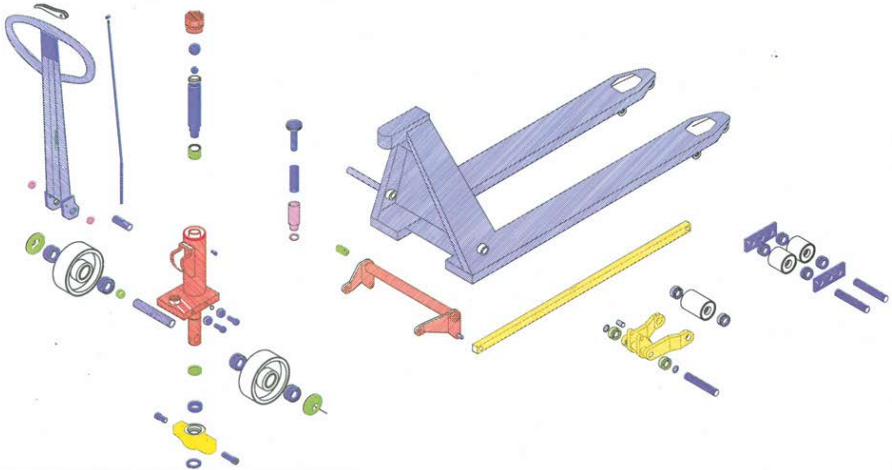

- Stainless steel
- Nylon/Pom
- Warmgalvanised steel
- Brass/Bronze
- Spraymetallised steel
- Alu

All pins, axles, bearings and bolts: stainless steel
 Stainless surfaces on pump, chassis, towbar, pushrod and rocker arm: shotblasted



MANUAL PALLET TRUCK TRPI0001

Semi-stainless steel

REF 100PS2224

- Stainless steel grade 304
- Load capacity: 2500 kg
- Centre of gravity: 500 mm
- Type of pump: standard
- Minimum height: 85 mm
- Lifting height: 200 mm
- **Length of the forks: 1000 mm**
- Maximum height (with handle): 1130 mm
- Total length of the pallet truck: 1400 mm
- **Total width: 520 mm**
- Own weight: 71 kg
- Material of the steering wheels: nylon
- Material of the fork wheels: tandem/nylon



Climax

MANUAL PALLET TRUCK TRPI0001

Semi-stainless steel

REF 100PS2225

- Stainless steel grade 304
- Load capacity: 2500 kg
- Centre of gravity: 500 mm
- Type of pump: standard
- Minimum height: 85 mm
- Lifting height: 200 mm
- **Length of the forks: 1000 mm**
- Maximum height (with handle): 1130 mm
- Total length of the pallet truck: 1400 mm
- **Total width: 685 mm**
- Own weight: 75 kg
- Material of the steering wheels: nylon
- Material of the fork wheels: tandem/nylon



Climax



MANUAL PALLET TRUCK TRPI0001

Semi-stainless steel

REF 100PS2226

- Stainless steel grade 304
- Load capacity: 2500 kg
- Centre of gravity: 565 mm
- Type of pump: standard
- Minimum height: 80 mm
- Lifting height: 200 mm
- **Length of the forks: 1130 mm**
- Maximum height (with handle): 1130 mm
- Total length of the pallet truck: 1530 mm
- **Total width: 520 mm**
- **Own weight: 75 kg**
- Material of the steering wheels: nylon
- Material of the fork wheels: tandem/nylon



Climax

MANUAL PALLET TRUCK TRPI0001

Semi-stainless steel

REF 100PS2227

- Stainless steel grade 304
- Load capacity: 2500 kg
- Centre of gravity: 565 mm
- Type of pump: standard
- Minimum height: 85 mm
- Lifting height: 200 mm
- **Length of the forks: 1130 mm**
- Maximum height (with handle): 1130 mm
- Total length of the pallet truck: 1530 mm
- **Total width: 685 mm**
- **Own weight: 78 kg**
- Material of the steering wheels: nylon
- Material of the fork wheels: tandem/nylon



Climax



MANUAL PALLET TRUCK TRPI0002

100%
stainless
steel

REF 100PS2228

- Stainless steel grade 304
- Load capacity: 2000 kg
- Centre of gravity: 565 mm
- Type of pump: standard
- Minimum height: 85 mm
- Lifting height: 200 mm
- **Length of the forks: 1130 mm**
- Maximum height (with handle): 1130 mm
- Total length of the pallet truck: 1530 mm
- **Total width: 520 mm**
- **Own weight: 70 kg**
- Material of the steering wheels: nylon
- Material of the fork wheels: tandem/nylon



Climax



MANUAL SCISSOR PALLET TRUCK TRSMI0001

REF 100PS2229

- Stainless steel grade 304
- Load capacity: 1000 kg
- Centre of gravity: 600 mm
- Type of pump: quick lift
- Free lifting height: 400 mm
- Lifting height: 800 mm
- Length of the forks: 1200 mm
- **Maximum height (with handle): 1230 mm**
- Maximum height: 1670 mm
- Total length of the pallet truck: 1650 mm
- Total width: 560 mm
- **Minimum aisle width: 1890 mm**
- Own weight: 122 kg
- Material of the steering wheels: polyurethane
- Material of the fork wheels: nylon

Semi-stainless steel



Climax

MANUAL SCISSOR PALLET TRUCK TRSMI0002

REF 100PS2230

- Stainless steel grade 304
- Load capacity: 1000 kg
- Centre of gravity: 600 mm
- Type of pump: quick lift
- Free lifting height: 400 mm
- Lifting height: 800 mm
- Length of the forks: 1200 mm
- **Maximum height (with handle): 1240 mm**
- Maximum height: 1670 mm
- Total length of the pallet truck: 1650 mm
- Total width: 560 mm
- **Minimum aisle width: 1850 mm**
- Own weight: 122 kg
- Material of the steering wheels: polyurethane
- Material of the fork wheels: nylon

100% stainless steel



Climax



SEMI-ELECTRIC SCISSOR PALLET TRUCK TRSE0001

REF 100PS2231

- Stainless steel grade 304
- **Load capacity: 1000 kg**
- **Centre of gravity: 600 mm**
- Type of pump: quick lift
- Free lifting height: 400 mm
- Lifting height: 800 mm
- Length of the forks: 1200 mm
- **Maximum height (with handle): 1230 mm**
- Maximum height: 1670 mm
- **Total length of the pallet truck: 1650 mm**
- Total width: 560 mm
- **Minimum aisle width: 1890 mm**
- **Own weight: 156 kg**
- Capacity of the battery: 50 Ah
- Material of the steering wheels: polyurethane
- Material of the fork wheels: nylon
- Power of the lift motor: 0,8 kW
- **Charger integrated**



Climax

SEMI-ELECTRIC SCISSOR PALLET TRUCK TRSEI0002

REF 100PS2232

- Stainless steel grade 304
- **Load capacity: 600 kg**
- **Centre of gravity: 1000 mm**
- Type of pump: quick lift
- Free lifting height: 400 mm
- Lifting height: 800 mm
- Length of the forks: 1200 mm
- **Maximum height (with handle): 1240 mm**
- Maximum height: 1680 mm
- **Total length of the pallet truck: 1600 mm**
- Total width: 560 mm
- **Minimum aisle width: 1800 mm**
- **Own weight: 155 kg**
- Capacity of the battery: 50 Ah
- Material of the steering wheels: polyurethane
- Material of the fork wheels: nylon
- Power of the lift motor: 0,8 kW
- **Charger integrated**



Climax



Did you know that a calibration certificate and/or legal-for-trade certificate are required for your handling equipment if it will be used for commercial purposes? These certificates are also necessary to comply with the Solas regulation, which requires that the gross weight of containers is known before they are loaded onto the ship.

Remember, there are three important reasons for having your weighing pallet trucks calibrated:

1. To ensure the accuracy of the weighing
2. To make sure that the pallet trucks show a reliable value
3. To ensure readings from the pallet truck are consistent with other measurements

Opt now for the weighing pallet trucks of our Climax range.



- ✓ Made in Europe
- ✓ Ergonomic position of the display
- ✓ High quality guaranteed
- ✓ All parts available

WEIGHING PALLET TRUCK TRWI0001

REF 100PS2233 – without printer

REF 100PS2234 – with printer

- Stainless steel grade 304
- Load capacity: 2000 kg
- Centre of gravity: 575 mm
- Type of pump: standard
- Min. height: 85 mm
- Lifting height: 205 mm
- Length of the forks: 1150 mm
- Maximum height (with handle): 1130 mm
- Total length of the pallet truck: 1550 mm
- Total width: 550 mm
- Capacity of the battery: 4 x 1,5 V
- Non-rechargeable battery
- Scale division 0-200 kg: 0,25 kg / 200-500 kg: 0,5 kg / 500-2000 kg: 1 kg
- Accuracy: 0,10% of full scale
- Material of the steering wheels: nylon
- Material of the fork wheels: nylon



Climax



WEIGHING PALLET TRUCK TRWI0002 - WITH CALIBRATION CERTIFICATE

REF 100PS2235 – without printer

REF 100PS2236 – with printer

- Stainless steel grade 304
- Load capacity: 2000 kg
- Centre of gravity: 575 mm
- Type of pump: standard
- Minimum height: 85 mm
- Lifting height: 205 mm
- Length of the forks: 1150 mm
- Maximum height (with handle): 1130 mm
- Total length of the pallet truck: 1550 mm
- Total width: 550 mm
- Capacity of the battery: 1,2 Ah
- Rechargeable battery
- Scale division 0-200 kg: 0,25 kg / 200-500 kg: 0,5 kg / 500-2000 kg: 1 kg
- Accuracy: 0,10% of full scale
- Material of the steering wheels: nylon
- Material of the fork wheels: nylon

100%
stainless
steel



Climax

WEIGHING PALLET TRUCK TRWI0003 - CALIBRATED (LEGAL FOR TRADE)

REF 100PS2237 – without printer

REF 100PS2238 – with printer

- Stainless steel grade 304
- Load capacity: 2000 kg
- Centre of gravity: 575 mm
- Type of pump: standard
- Minimum height: 85 mm
- Lifting height: 205 mm
- Length of the forks: 1150 mm
- Maximum height (with handle): 1130 mm
- Total length of the pallet truck: 1550 mm
- Total width: 550 mm
- Capacity of the battery: 1,2 Ah
- Rechargeable battery
- Scale division 0-200 kg: 0,25 kg / 200-500 kg: 0,5 kg / 500-2000 kg: 1 kg
- Accuracy: 0,10% of full scale
- Material of the steering wheels: nylon
- Material of the fork wheels: nylon

100%
stainless
steel



Climax



MANUAL LIFT TABLE HFTI0001

Semi-
stainless
steel

REF 100PS2239

- Stainless steel grade 304
- **Load capacity: 100 kg**
- Total length: 1050 mm
- Platform length: 700 mm
- Platform width: 445 mm
- Lift height: 970 mm
- Handle height: 1220 mm
- Total width: 830 mm
- Minimum platform height: 250 mm
- Own weight: 59 kg
- Fixed handle
- Foot brake
- Wheels: polyurethane



Climax

MANUAL LIFT TABLE HFTI0002

Semi-
stainless
steel

REF 100PS2240

- Stainless steel grade 304
- **Load capacity: 250 kg**
- Total length: 1120 mm
- Platform length: 815 mm
- Platform width: 500 mm
- Lift height: 600 mm
- Handle height: 890 mm
- Total width: 1020 mm
- Minimum platform height: 290 mm
- Own weight: 69 kg
- Fixed handle
- Foot brake
- Wheels: polyurethane



Climax

MANUAL LIFT TABLE HFTI0003

Semi-
stainless
steel

REF 100PS2241

- Stainless steel grade 304
- **Load capacity: 350 kg**
- Total length: 1150 mm
- Platform length: 915 mm
- Platform width: 500 mm
- Lift height: 940 mm
- Handle height: 1295 mm
- Total width: 1030 mm
- Minimum platform height: 355 mm
- Own weight: 101 kg
- Fixed handle
- Foot brake
- Wheels: polyurethane



Climax

MANUAL LIFT TABLE HFTI0004

Semi-
stainless
steel

REF 100PS2242

- Stainless steel grade 304
- **Load capacity: 450 kg**
- Total length: 1130 mm
- Platform length: 815 mm
- Platform width: 500 mm
- Lift height: 600 mm
- Handle height: 890 mm
- Total width: 1000 mm
- Minimum platform height: 290 mm
- Own weight: 81 kg
- Fixed handle
- Foot brake
- Wheels: polyurethane



Climax



TABLE TROLLEY - 2 SHELVES

Semi-stainless steel

REF 100PS2243

- Stainless steel grade 304
- Load capacity: 100 kg
- Total length: 700 mm
- Total width: 450 mm
- Total height: 900 mm
- Own weight: 9 kg
- Length of the loading platform: 610 mm
- Width of the loading platform: 410 mm
- Number of castor wheels: 4
- Diameter of the castor wheels: 100 mm
- Material of the wheels: rubber
- Material of the loading platform: stainless steel
- Material of the swivel castors: rubber



TOTAL SOURCE®

TABLE TROLLEY - 3 SHELVES

Semi-stainless steel

REF 100PS2244

- Stainless steel grade 304
- Load capacity: 100 kg
- Total length: 610 mm
- Total width: 410 mm
- Total height: 900 mm
- Own weight: 11 kg
- Length of the loading platform: 610 mm
- Width of the loading platform: 410 mm
- Number of castor wheels: 4
- Diameter of the castor wheels: 100 mm
- Material of the wheels: rubber
- Material of the loading platform: stainless steel
- Material of the swivel castors: rubber



TOTAL SOURCE®

MINIPULLER MPLI0001

REF 100PS2245

- Pulling power: 1000 kg
- Drive control: freely programmable speed
- Drive: DC motor 24 V, 300 W
- Removable battery 24 V, 18 Ah
- External charger
- Tyres: solid (250 x 85 mm)
- Frame: stainless steel, zinc-plated and powder-coated
- Width: 440 mm
- Length: 600 mm
- Working height tiller handle: 750-1150 mm
- Folded height: 770 mm
- Own weight: 43 kg
- Standard equipped with: battery discharge indicator, adjustable tiller handle, CE-certificate, brake, basic module, battery and external battery charger
- Options: second battery, horn, special hooks
- With special hook: REF 100PS2246 (see picture)



Climax



SALT SPREADER

TOTALSOURCE®

REF 100PS1073

- Width: 910 mm
- Height: 1050 mm
- Gritting range: 1-6 m
- Capacity: 180 kg
- Volume: 149 l
- Mounting: coupling for forklift
- For sand, salt and grit
- Pneumatic tyres



REF 100PS1071

- Covering sheet salt spreader
- Diameter: 920 mm
- Accessory for [REF 100PS1073](#)



ROLL-FORWARD SKIP

100%
stainless
steel



cam
s y s t e m
LIFT TRUCK ATTACHMENTS

Volume (l)	Width (mm)	Height without wheels (mm)	Length (mm)	Weight (kg)	Max fork section (mm)	Min distance between forks (mm)	Capacity (kg)	Castors	REF
600	855	870	1525	111	230 x 95	160	1500	Without castors	100PS2247
								With nylon castors	100PS2248
								With rubber castors	100PS2249
900	1215	870	1525	128	230 x 95	160	1500	Without castors	100PS2250
								With nylon castors	100PS2251
								With rubber castors	100PS2252



STAINLESS STEEL CLEANER - 10 L

REF 100PS2261

- Biodegradable
- Extremely strong, concentrated alkaline foam cleaner
- Suitable for the removal of almost all common contaminants in the food industry
- Saponifies and effortlessly removes pollutants based on vegetable and animal fats and oils, proteins and similar contaminants



FOOD GREASE - 500 ML

REF 100PS2253

- Multipurpose grease with long-term lubrication on food processing equipment, where incidental food contact may occur
- Registered NSF H1 for use in the food industry
- This aluminium complex grease has a good thermal stability with an operating temperature up to 140 °C and protects against corrosion
- Can be applied on all metal constructions used in the food industry: hinges, valves, chains, gears, joints ...





INDUSTRIAL DEGREASER - 500 ML



REF 100PS2254

- Heavy-duty cleaner which dissolves and removes grease, oil, lubricants, adhesives and contaminants from equipment, machinery and metal parts
- Can also be used as a carbon remover in food processing areas
- NSF A8 and K1 certified



STAINLESS STEEL KLEEN - 500 ML



REF 100PS2255

- Water-based, foaming cleaner for degreasing and cleaning shiny metal surfaces
- The product combines a high cleaning power with the application of a durable protective coating, in one step
- NSF C1 registered for use in the food industry





INDUSTRIAL GREASE GUN

REF 100PS2256

- Capacity: 500 cc M 10x1
- With 1 high-pressure hose: 11 x 300 mm
- With 1 angled spout, 2 precision machined hydraulic couplers, 4 jaws
- Operates with grease
- Sealing system: o-ring and ball valve prevent grease compressed in the grease gun head from feeding back
- Designed to be utilised under rough conditions with variable stroke system



LOW TEMPERATURE EXTREME-PRESSURE GREASE – 400 G

REF 100PS2262

- Calcium sulfonate complex grease, recommended for various applications in the food and food related industry operating under severe conditions (high load, high temperature, water, dust)
- Very suitable to lubricate pelleting presses
- NSF H1 registered: No 147140 and ISO 21469 certified
- Assures long machine life while reducing contamination problems as required by the Hazard Analysis and Critical Control Point System (HACCP)
- Excellent thermal stability. It regains its original texture after cooling to ambient temperature
- Extraordinary water resistance, no significant loss of consistency is observed even with high amounts of water entering the grease





BIODEGRADABLE HYDRAULIC FLUID - 20 L



REF 100PS2260

- Oil for hydraulic systems presenting risks of leaks of fluid into the environment and incidental contact with food: grape harvests, crop harvests ...
- Reinforced protection and efficiency of equipment due to a very high viscosity index
- Excellent anti-wear properties
- Operating temperatures: -20 °C to 70 °C
- NSF H1 / ISO 15380 HETG / Poclairn Hydraulics 11-06 / ISO 6743-4



HYDRAULIC OIL FOR COLD STORE APPLICATIONS

REF 100PS1264

- ISO VG15
- 5 l

REF 100PS2258

- ISO VG22
- 20 l

REF 100PS2259

- ISO VG32
- 20 l



TOTAL SOURCE

Recommended for all kinds of hydraulic systems operating under high pressure (limit as indicated by the pump manufacturer) and high temperature.

- Lubricants especially suitable for hydraulic systems working under extreme temperature variations and equipment operating outdoors: easy start up at low temperature and regular operating in all seasons
- Superior thermal stability avoiding the formation of sludge even at high temperatures
- High protection against wear insuring maximum equipment life
- Good anti-foam and air release properties by using silicon free components



A series of horizontal dotted lines for writing notes.



A series of horizontal dotted lines for writing notes, spanning the width of the page.

Product specials



AT YOUR SERVICE
IN 37 LANGUAGES
info@tvh.com



Order your copy

· Air conditioning	REF 31346611	· Lubrication & accessories	REF 21841408
· Document & accessories holders	REF 14372877	· Mirrors	REF 20778928
· Drum handling & accessories	REF 21735662	· Presses	REF 17868205
· Electronic accessories	REF 31642339	· Safety products	REF 31773321
· Force professional tools	REF 22835159	· Safety equipment for aerial work platforms	REF 28975226
· Forks & accessories	REF 31642343	· Skips, scoops & crane jibs	REF 20963014
· Hydraulic power units	REF 21713854	· Summertime products	REF 36108454
· Jacks & supports	REF 18178749	· Winter products	REF 33825047
· LED lights	REF 22775197		



FOLLOW US



PARTS & ACCESSORIES



COMPANY MOVIE

Go to **downloads** on **www.tvh.com** to find all catalogues, brochures and movies.



TVH PARTS NV
Brabantstraat 15 · 8790 Waregem · Belgium
T +32 56 43 42 11 · F +32 56 43 44 88 · info@tvh.com · www.tvh.com

TVHPARTS